

## Modern Porsche - Competition

### **Precise Hydraulic Damping**

All our dampers feature low seal friction together with high flow hydraulics and a large diameter pistons, giving a damping system that dissipates energy from the first millimetre of movement.

### **Low Friction Front Strut**

From our rally systems, EXE-TC are now proud to offer a completely unique system, not available for the Porsche platform until now. Our main objective is to reduce the inherent friction in the traditional MacPherson strut design, while maintaining the stable and consistent performance of the inverted damper setup.

### **Softer progressive springs**

The use of this type of spring allows for reduced rebound damping control, for instant wheel release/drop out while still retaining control over the tyre movement - enhancing mechanical grip, increase tyre life and produces a smoother ride. The sensitive damping controls the chassis and tyre movement, ultimately resulting in greater driver confidence through a stronger feeling for the track.

### **Top mounts**

All our sets for modern Porsche include top mounts front and rear, each with a bespoke aluminium housing and mounting plate and steel spherical bearing. All our models except the 991 feature adjustable front top mounts. Adjustable in of both caster and camber. Two camber options are available for the 991. Rubber spacers are available on all models to reduce vibration to the chassis.

### **Coating and protection**

We know, from our many years experience in the World Rally Championship, that our suspension has to first and foremost, be reliable. We achieve this by continually pursuing the latest technology in surface treatments and coatings, ultimately producing a product that will maintain its functionality and performance. We carry this philosophy throughout our entire range of products.

### **Bespoke orders and setup**

With a team of design engineers on-site, along with a full CNC machine shop, we can offer bespoke designs manufactured in-house. Set up and damper characteristics can also be altered to suit your needs. Contact one of our engineers to further discuss your specific requirements.





# exe-tc competition

## S U S P E N S I O N

### 996/997

- 3-way dampers
- Adjustable Front Top Mount
- Non-adjustable Rear Top Mounts
- Optional Rear Subframe Spacer
- Supplied with Rear ARB Mount if req.
- Choice of Progressive or Linear Springs

### 991

- 3-way dampers
- Non-adjustable Front Top Mount
  - 2 Camber positions available
- Non-adjustable Rear Top Mounts
- Quick-disconnect Rear Hoses
- Choice of Progressive or Linear Springs

### 964/993

- 3-way dampers
- Adjustable Front Top Mount
- Non-adjustable Rear Top Mounts
- Fitment to all years/variants
- Supplied with Rear ARB Mount if req.
- Choice of Progressive or Linear Springs

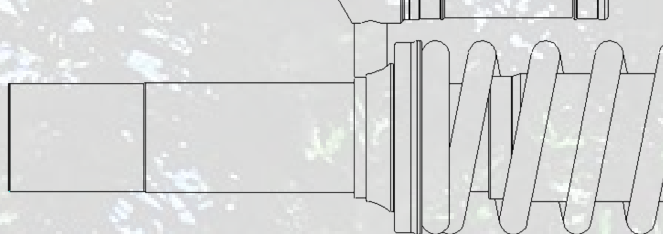

MODEL	SURFACE	PART NUMBER	RETAIL (ex.VAT)
996/997 Cup	Tarmac Rally	CCP09/11-1004/1005	£ 6,195.00
	Irish Tarmac Rally	CCP09/11-1004/1005/B	£ 6,550.00
	Circuit	CCP09/11-1006/1007	£ 6,195.00
996/997 GT2/GT3 (RS)	Tarmac Rally	CCP09/11-1010/1011	£ 6,195.00
	Circuit	CCP09/11-1012/1013	£ 6,195.00
991 Cup	Tarmac Rally	CCP14-1104/1005	£ 6,895.00
	Circuit	CCP14-1106/1007	£ 6,895.00
991 GT3 (RS)	Circuit	CCP14-1110/1011	£ 6,895.00
987	Tarmac Rally	CTP15-1004/1005	£ 6,695.00
964 / 993	Circuit	CCP04-1008/1009	£ 6,595.00

\*4-way adjustable. All prices excluding VAT, taxes and shipping

All models are 3-way adjustable unless stated. Prices include Top Mounts. Additional information is required to confirm installation and setup.

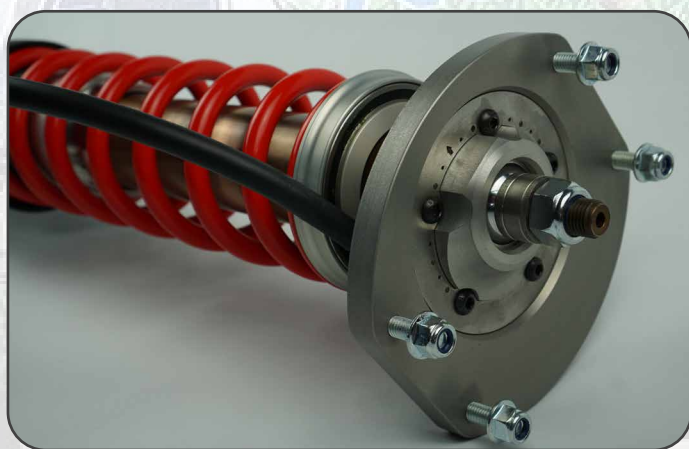

### Safari Systems

Also unique to EXE-TC is our purpose-built Safari-spec systems. Available for the 911 from 1969, to the 993 generation, our 4-way adjustable systems with 45mm pistons and adjustable hydraulic bump stops.

964 & 993 generation systems are available direct from EXE-TC. Springs and top mounts are included. Contact EXE-TC for more information and availability.

MODEL	SURFACE	PART NUMBER	RETAIL
964 / 993	Safari Rally	CP17-1102/1003	£7,440.00

All prices excluding taxes and shipping

For enquiries and info:  
Email: [sales@exe-tc.co.uk](mailto:sales@exe-tc.co.uk)  
Phone: +44 (0) 1392 444490  
[www.exe-tc.co.uk](http://www.exe-tc.co.uk)

EXE-TC Ltd.  
2 Omega Centre, Bittern Road  
Exeter, Devon  
UK, EX2 7LT